



DISPENSE  
SYSTEMS  
INTERNATIONAL

# MOUNTING - DISMOUNTING ASSEMBLING - DISASSEMBLING INSTRUCTION

for

DSI Extractor Tube

ET-GR, GRS, GRSI

ET-AC, ACS, ACSI



INSTRUCTION

**Quality Management:**

Michael Brüseke: (0049) (0)2385-772-512  
*e-mail: brueseke@dsi-group.net*

Yilmaz Kodas: (0049) (0)2385-772-452  
*e-mail: kodas@dsi-group.net*

**Technical Department:**

Christof Tuneke: (0049) (0)2385-772-430  
*e-mail: tuneke@dsi-group.net*

**Sales Department:**

**DSI Hamm**

Sabine Groneberg: (0049) (0) 2385-772-212  
*e-mail: groneberg@dsi-group.net*

Sandra Leszynsky: (0049) (0) 2385-772-214  
*e-mail: leszynsky@dsi-group.net*

Renate Stosiek: (0049) (0) 2385-772-213  
*e-mail: stosiek@dsi-group.net*

**DSI GETRÄNKEARMATUREN GmbH**  
Gewerbepark Hamm-Rhynern  
Oberster Kamp 20, 59069 Hamm-Rhynern, Germany  
Tel: +49 (0) 23 85-77 21 00  
Fax: +49 (0) 23 85-77 22 49  
E-mail: [info@dsi-group.net](mailto:info@dsi-group.net)  
internet: [www.dispensegroup.com](http://www.dispensegroup.com)

**DSI CZECH REPUBLIC**  
Závodni 50  
CZ-36006 Karlovy Vary · Czech Republic  
Tel: +4 20 (0) 35-3 44 90 25  
Fax: +4 20 (0) 35-3 44 90 25  
E-mail: [dsi@volny.cz](mailto:dsi@volny.cz)

**DSI – U.K.**

Unit 2  
Ealand Industrial Estate  
Ealand, Scunthorpe  
North Lincoln Shire, DN17 4JW  
United Kingdom  
Tel: +44 (0) 17 24 71 23-77  
Fax: +44 (0) 17 24 71 23-88  
E-mail: [dsiservicecenter@aol.com](mailto:dsiservicecenter@aol.com)

Honoured partners,

You are welcome in the world of D.S.I. Dispense Systems International

More than 100 years of development and success leave behind us.

Companies as Fuge, Breitwisch, VHS or Germefa have given us a solid basis of know-how and experience on the sector of beverage technology in the past.

On this basis we have built up a new vision and have created something very Unique:

D.S.I. Unique Draught Technologies

We the D.S.I. team, resolutely focus our attention on new market orientated technologies which correspond to the requirements of our customers. We are thinking in the same way as you and especially we think in advance.

In the middle of Germany, located in Hamm/Westphalia we opened up a new chapter of our company history and set up a new manufacturing plant. This enables our 100 employees to utilise these optimal conditions for developing and manufacturing brand-new products. At the same time the certificate and review of ISO 9001 represents the principle for our high-grade quality management and obligation. Particularly one objective emphasises all our efforts.

The safety of your product with our greatest care and precision, equal whether you are filling, taping or you intend to dispense without problems. We aim to offer you 100% quality from production up to consumption.

We see ourselves as your partner in the field of beverage industries and offer you a constructive dialogue about solutions to the necessary tasks we are faced with every day. For this D.S.I. takes the responsibility with its well-known name. We are prepared to be challenged by you.

Please do it.

With kind regards



Harald Steinmetz  
-General Manager-

MOUNTING - DISMOUNTING  
ASSEMBLING - DISASSEMBLING  
INSTRUCTION  
TECHNICAL INFORMATION

ET-GR, GRS, GRSI

ET-AC, ACS, ACSI

ET-GR, GRS, GRSI

ET AC, ACS, ACSI



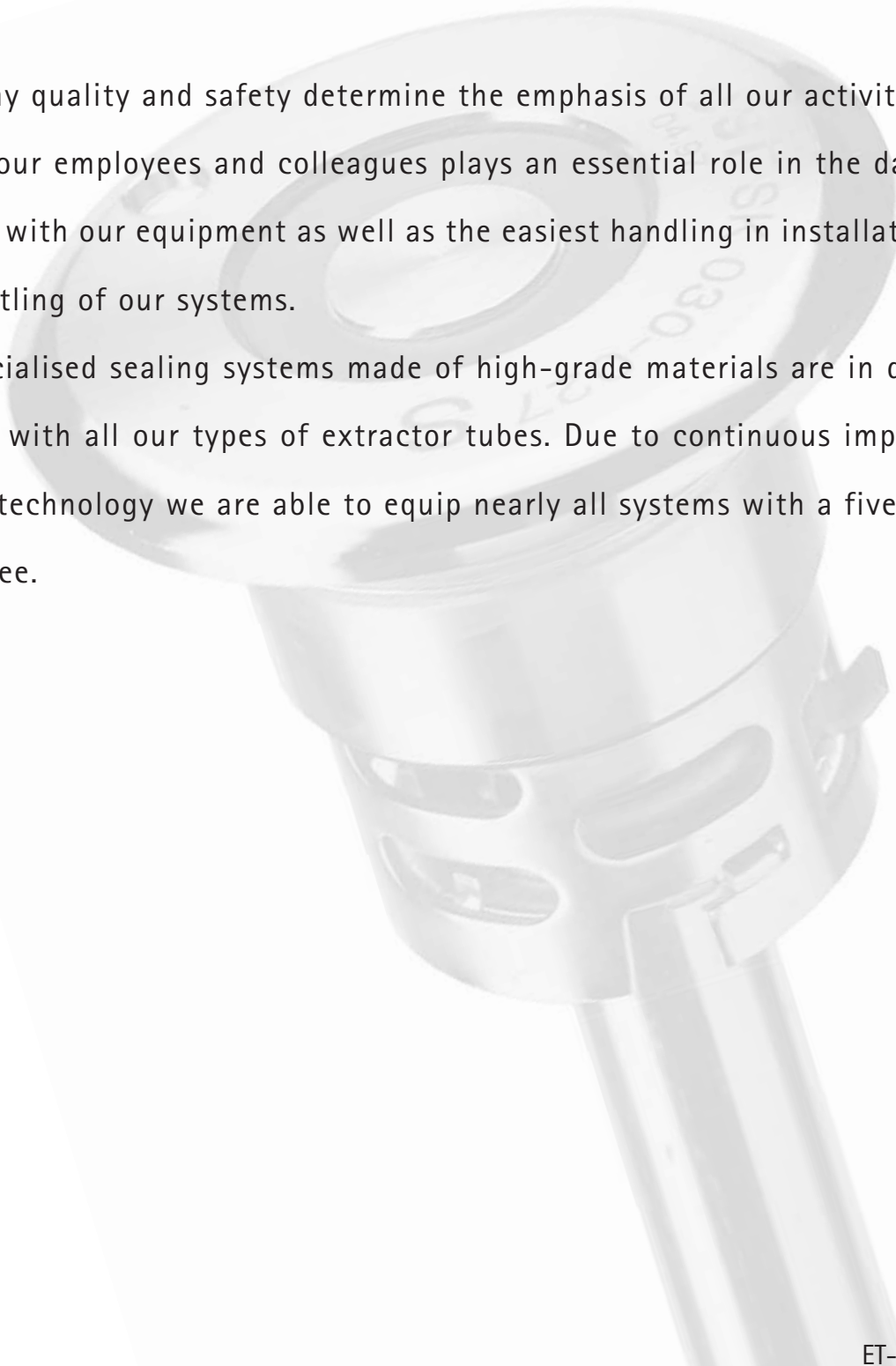

Today quality and safety determine the emphasis of all our activities. Security of your employees and colleagues plays an essential role in the daily application with our equipment as well as the easiest handling in installation and dismantling of our systems.

Specialised sealing systems made of high-grade materials are in daily utilisation with all our types of extractor tubes. Due to continuous improvement of our technology we are able to equip nearly all systems with a five year's guarantee.

1. Mounting instruction
2. Dismounting instruction
3. Disassembling intruction
4. Assembling instruction
5. Listing of required tools
6. Technical information
7. Dimensions

## 1. Mounting instruction

ET-GR, GRS, GRSI



ET AC, ACS, ACSI



## FITTING INSTRUCTION A)

### EXTRACTOR TUBE AC/GR



Moisten the Extractor Tube in water  
(preferably with washing-up liquid  
added)



Check if the keg neck is clean



Check if lock/safety is O.K.

Insert the Extractor Tube straight

## FITTING INSTRUCTION B)

### EXTRACTOR TUBE AC/GR



Push the Extractor Tube in the keg by hand



Tighten the spear, e. g. with the DSI Screw-in/screw out tool.  
The mounting torque (continous) must be  $80 \pm 5$  Nm.

Tool for Type AC: 550426.8

Tool for Type GR: 550425.7



Ready

## 2. Dismounting instruction

ET-GR, GRS, GRSI



ET AC, ACS, ACSI





Decompress the keg, e.g. by means of the DSI Decompression Tool  
article-no.: 550423.5



Unscrew the Extractor Tube completely,  
e.g. with the DSI Screw-in/Screw-out  
Tool:

AC = article-no.: 550426.8

GR = article-no.: 550425.7

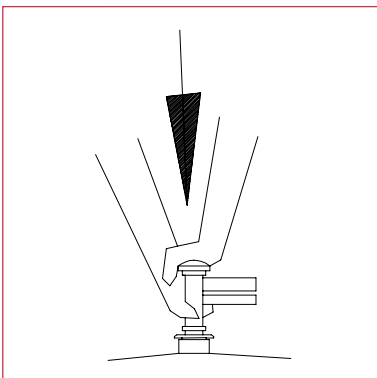

Click the Removal Tool  
article-no.: 027436.2 on the Extractor  
Tube by pushing it onto the rubber  
valve. **ATTENTION PLEASE:** Don't press  
the handles until the Extractor Tube is  
released from the keg!  
(see step 7).

## REMOVAL INSTRUCTION

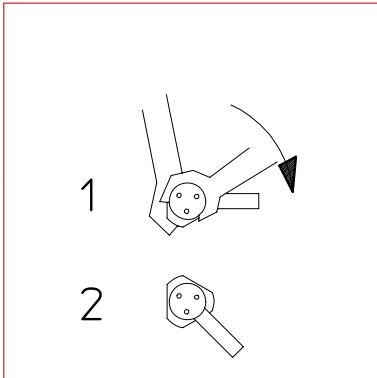

Turn the Tool clockwise with 1 hand while holding the flange of the Extractor Tube in place with the other hand.

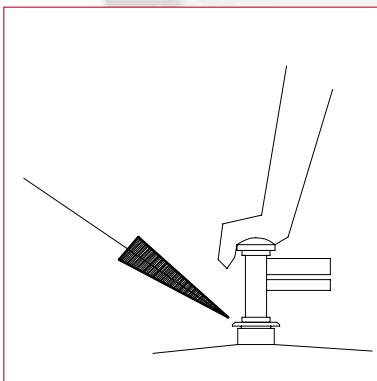

Push the Tool down with 1 hand while holding the flange with the other hand.

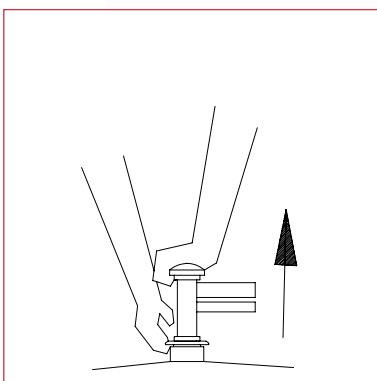

Lift tool and Extractor Tube at the same time from the keg.

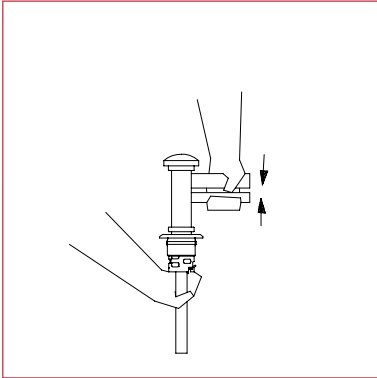

Now the Extractor Tube is removed from the keg.

It can be released from the Tool in 2 ways:

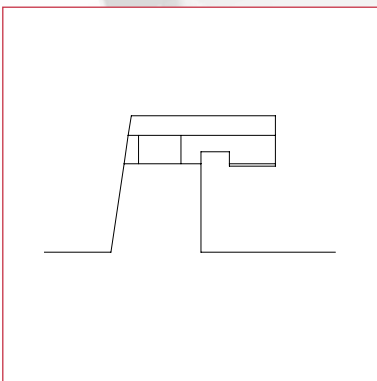

1. Disassemble the Extractor Tube by pressing the handles.

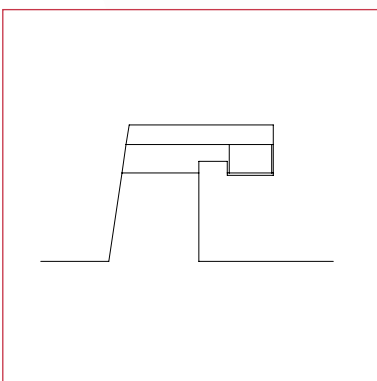

2. Turn the tool anticlockwise with 1 hand while holding the flange of the Extractor Tube in place with the other hand. Press the handles and the tool will be released without disassembling the Extractor Tube.

### 3. Disassembling instruction

ET-GR, GRS, GRSI



ET AC, ACS, ACSI



## DISASSEMBLING A DSI EXTRACTOR TUBE



Place the extractor tube in the tool

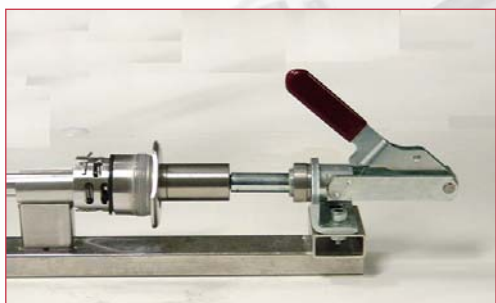

Close the handle



Remove the body from the extractor tube



Remove the seal with the fork at the end of the tool



The extractor tube is disassembled

## DISASSEMBLING INSTRUCTIONS EXTRACTOR TUBE AC/GR - NORMAL BODY

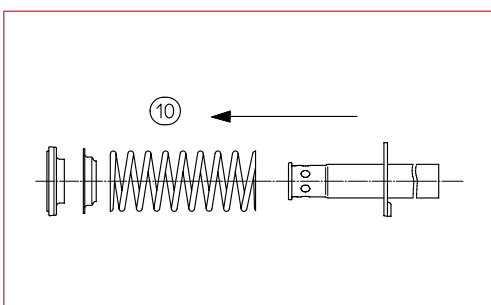
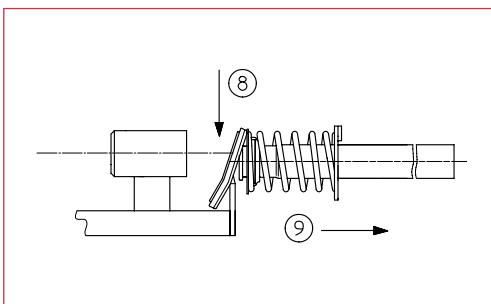
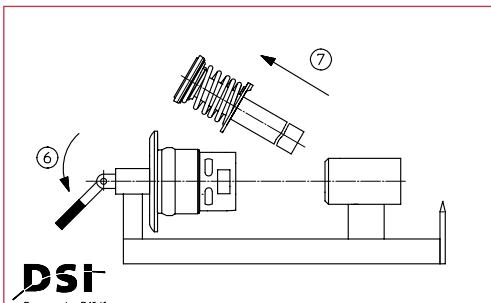
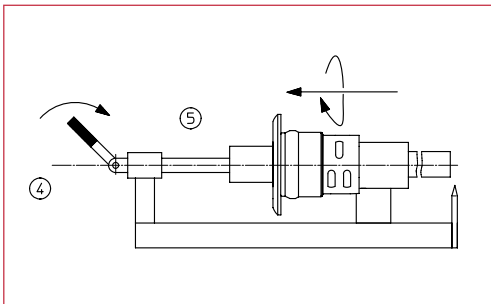
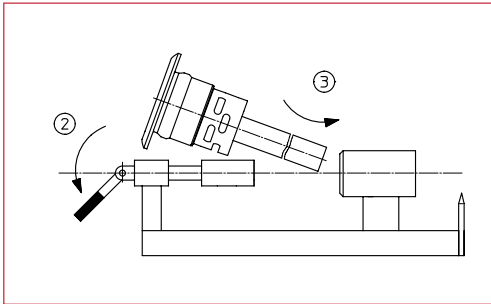

1. If the Extractor Tube has a Safety Latch, first follow Disassembling Instruction of the safety latch.
2. Push the handle of the DSI Disassembling Tool 550429.0 backward.
3. Put the extractor tube in the assembling tool with the safety latch hole in the sleeve.
4. Push the handle forward.
5. Turn the body clockwise and move the body onto the ringnut
6. Push the handle backward.
7. Take the tube out of the tool.
8. Push the tool-fork between the valve and the metal part.
9. Remove the valve by pulling the tube away from the fork
10. Take off the remaining parts.

## DISASSEMBLING INSTRUCTIONS EXTRACTOR TUBE GR - SHORT BODY

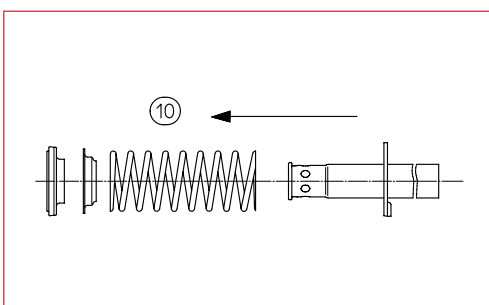
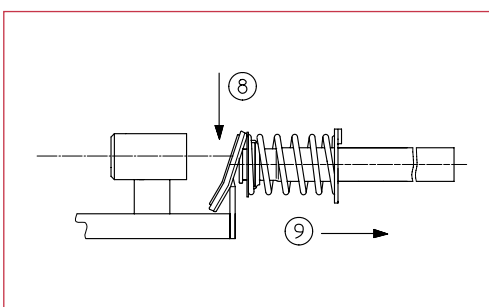
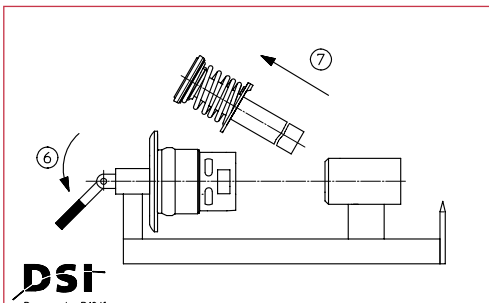
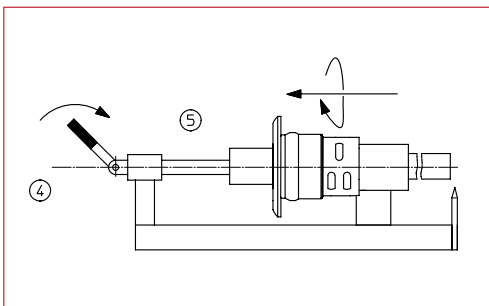
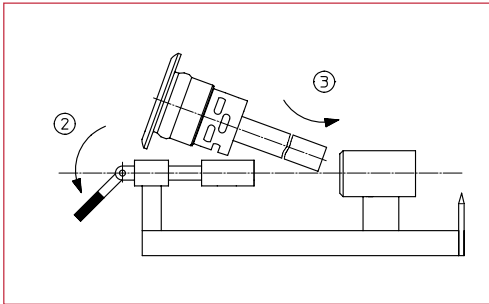

1. If the Extractor Tube has a Safety Latch, first follow Disassembling Instruction of the safety latch.
2. Push the handle of the DSI Disassembling Tool 555318.5 backward.
3. Put the extractor tube in the assembling tool with the safety latch hole in the sleeve.
4. Push the handle forward.
5. Turn the body clockwise and move the body onto the ringnut
6. Push the handle backward.
7. Take the tube out of the tool.
8. Push the tool-fork between the valve and the metal part.
9. Remove the valve by pulling the tube away from the fork
10. Take off the remaining parts.

## ASSEMBLING INSTRUCTIONS SAFETY LATCH AC/GR

### Assembling Instructions

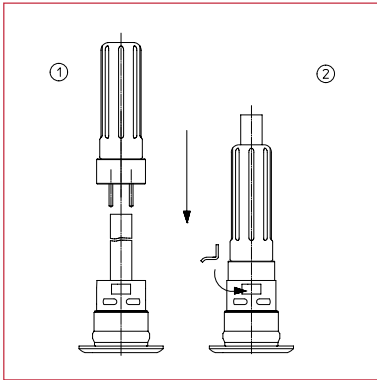

Put the (De)mounting Haft 550431.2, with the two pins in the holes compressing the spring, on the tube.

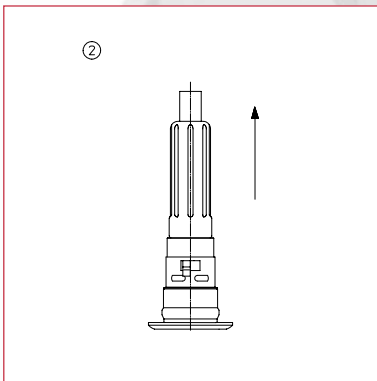

Position the latch in the body with the flat side against the tube and the ben-  
ded side pointing to the top of the body.

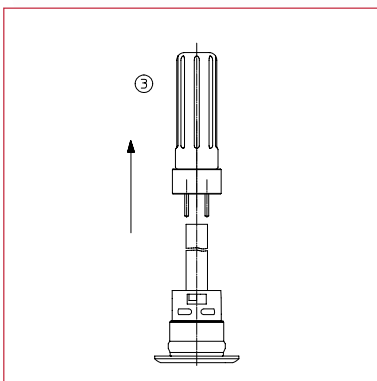

Take off the tool.

### Disassembling Instructions safety latch

Repeat the steps in the opposite order  
(3 to 1)

## 4. Assembling instruction

ET-GR, GRS, GRSI



ET AC, ACS, ACSI



## ASSEMBLING A DSI EXTRACTOR TUBE



Replace the sealing ring on the body

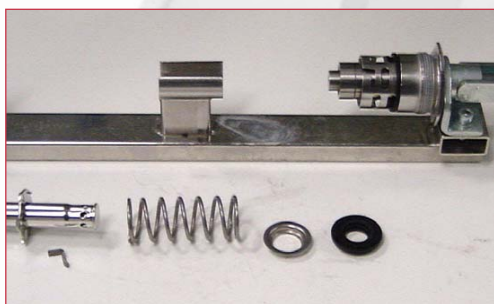

Put the body on the tool and get all the parts  
Moisten the rubber part in water



Place all the parts in the tool



Turn the handle until the rubber is in place

## ASSEMBLING A DSI EXTRACTOR TUBE

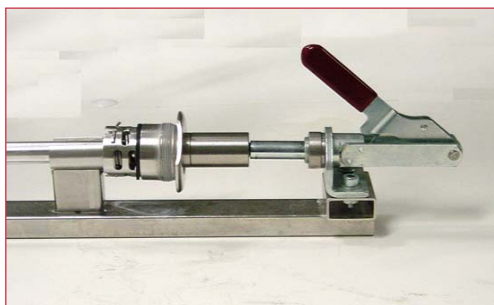

Move the body in place



Turn the body to lock  
Check if lock/safety is ok.



Open the handle, the extractor tube is ready

## ASSEMBLING

### Assembling Instructions Extractor Tube AC/GR normal Body:

When refurbishing an Extractor Tube, always replace the Body seal.

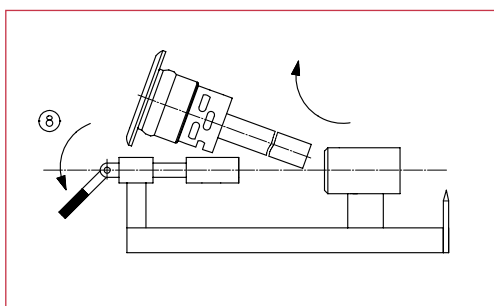
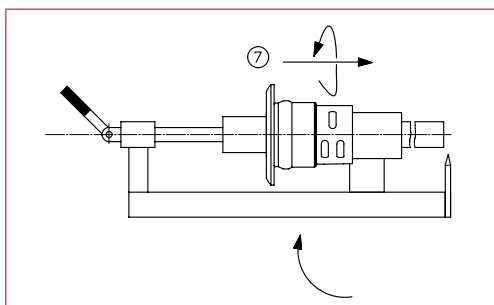
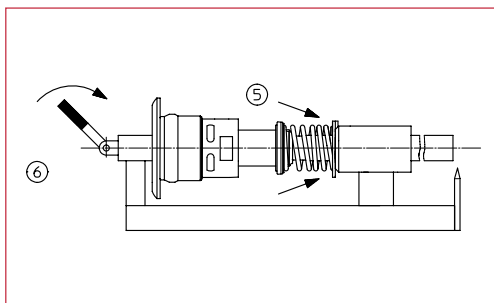
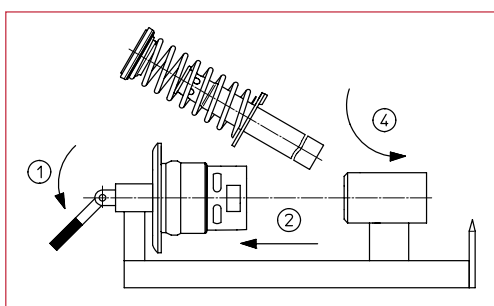
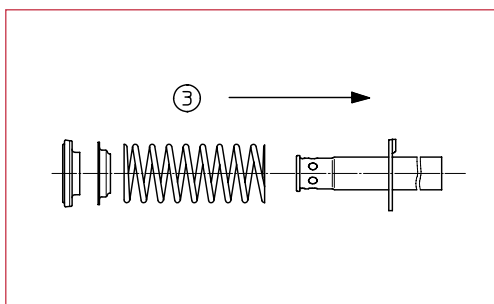

1. Push the handle of the DSI Assembling Tool 550429.0 backward.
2. Move the body onto the ringnut (near the handle).
3. Put the parts together on the tube.
4. Put the extractor tube in the assembling tool with the safety latch hole on the locking plate in the sleeve opening.
5. Centre the spring between the guides on the locking plate.
6. Mount the valve on the tube by pushing the handle forward.
7. Move the body to the locking plate (safety latch hole on top) and turn it anticlockwise after the body is positioned in the lugs.
8. Push the handle backward and take out the extractor tube.
9. If a Safety Latch is applicable, please follow the Assembling Instruction of the safety latch.

## ASSEMBLING

### Assembling Instructions Extractor Tube AC/GR short Body:

When refurbishing an Extractor Tube, always replace the Body seal.

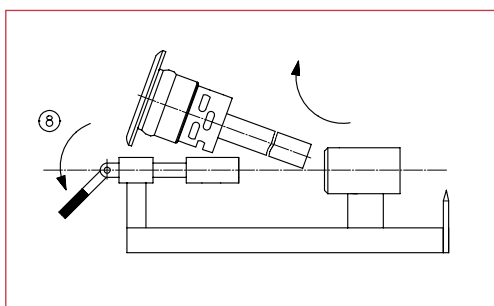
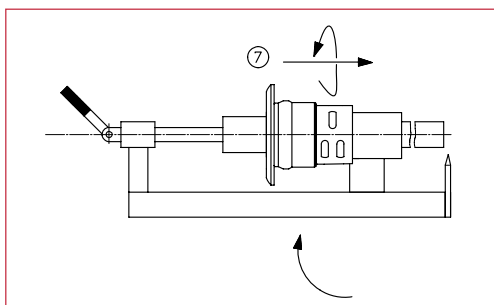
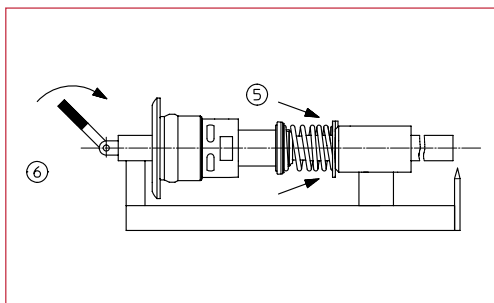
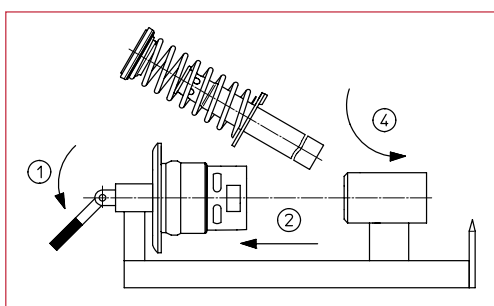
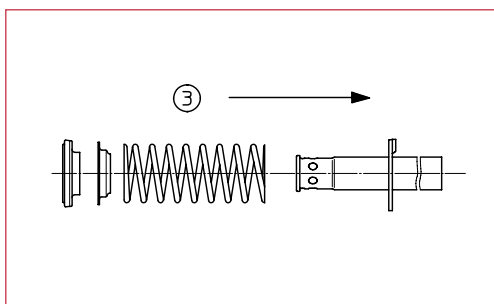

1. Push the handle of the DSI Assembling Tool 5555318.5 backward.
2. Move the body onto the ringnut (near the handle).
3. Put the parts together on the tube.
4. Put the extractor tube in the assembling tool with the safety latch hole on the locking plate in the sleeve opening.
5. Centre the spring between the guides on the locking plate.
6. Mount the valve on the tube by pushing the handle forward.
7. Move the body to the locking plate (safety latch hole on top) and turn it anticlockwise after the body is positioned in the lugs.
8. Push the handle backward and take out the extractor tube.
9. If a Safety Latch is applicable, please follow the Assembling Instruction of the safety latch.

## 5. Listing of required tools

ET-GR, GRS, GRSI



ET AC, ACS, ACSI



## TOOLS, FLAT TYPE EXTRACTOR TUBES WITH THREAD



Screw-in / screw-out tool, round  
74,5 mm

article-no.: 550426.8



Screw-in / screw-out tool, round 68 mm

article-no.: 554701.4

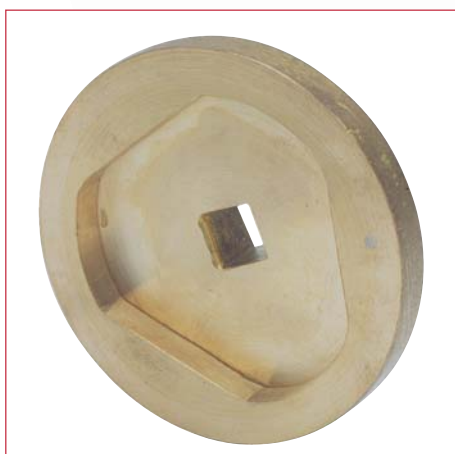

Screw-in / screw-out tool, trilobe

article-no.: 550425.7

## TOOLS, FLAT TYPE EXTRACTOR TUBES WITH THREAD



Assembling and disassembling tool  
for Extractor Tube with

short Body

article-no.: 555318.5

standard Body

article-no.: 550429.0



Release tool for removing extractor  
tubes from the keg

(Unsuitable for Extractor Tube (-Body)  
with 'safety gap')

article-no.: 027436.2



(De-)mounting haft for safety latch

article-no.: 550431.2

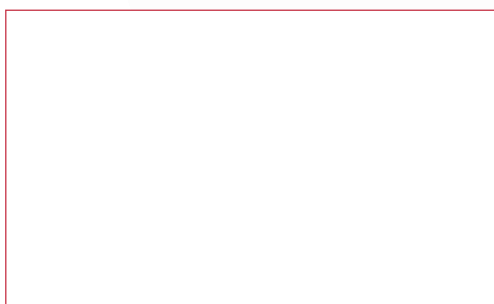

Pressure releaser

Decompression tool

article-no.: 550423.5

(no picture available)

## 6. Technical information

ET-GR, GRS, GRSI



ET AC, ACS, ACSI



## EXTRACTOR TUBE GRS (FLAT, TRI-LOBE)

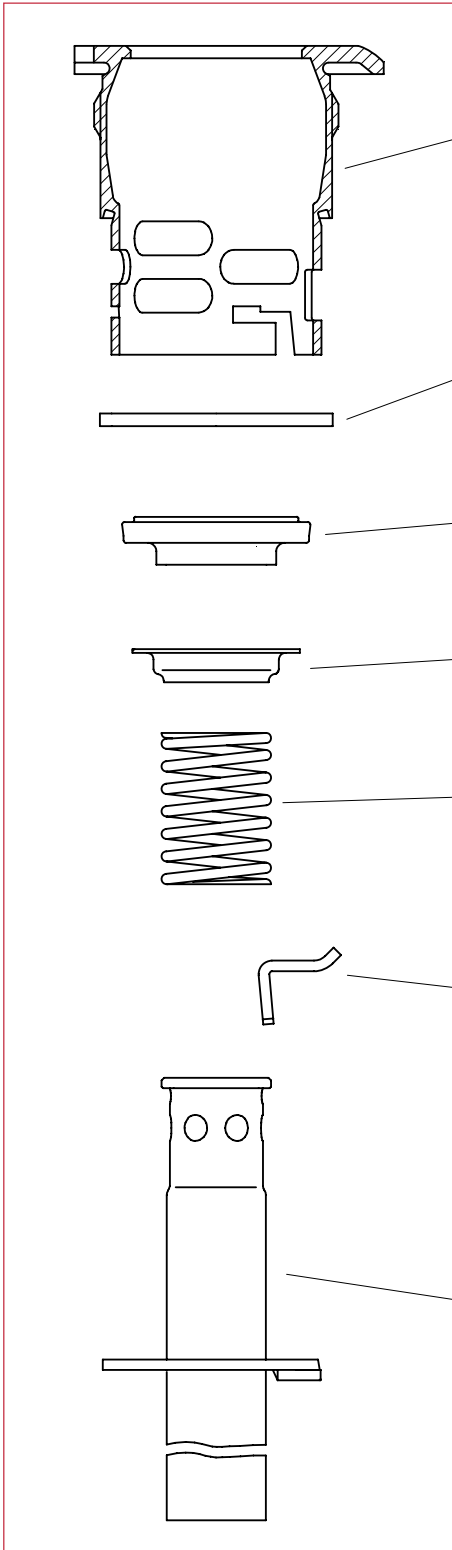

Body Stainless steel

Sealing ring Rubber

Main seal Rubber

Main seal plate stainless steel

Spring Stainless steel

Latch Stainless steel

Tube Stainless steel

## EXTRACTOR TUBE GRSI (FLAT, TRI-LOBE)

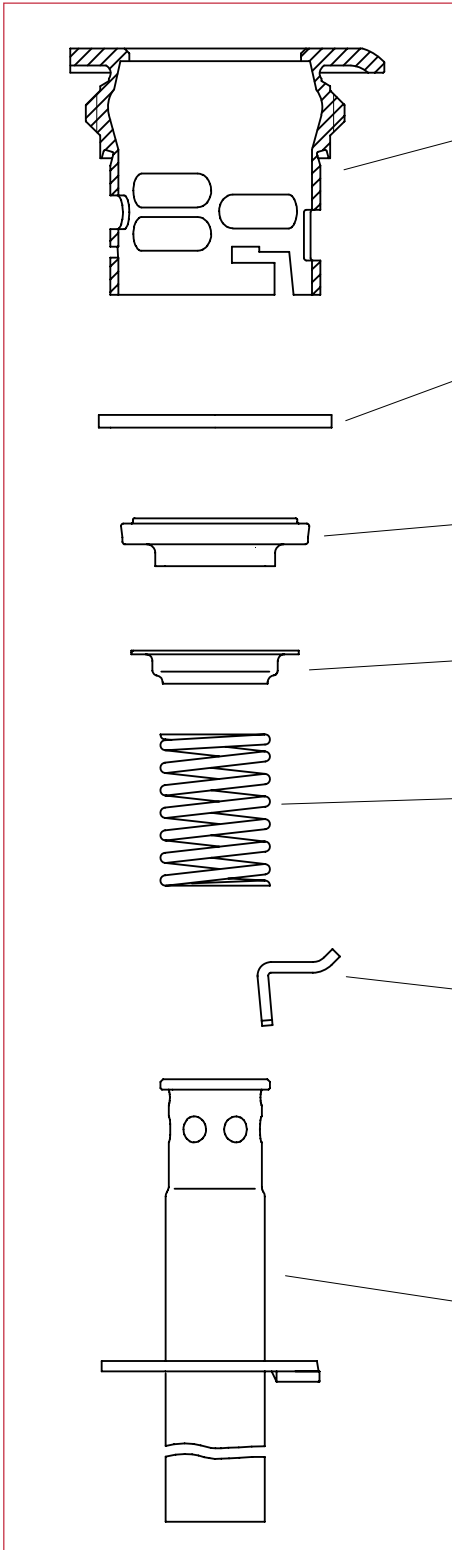

Body Stainless steel

Sealing ring Rubber

Main seal Rubber

Main seal plate stainless steel

Spring Stainless steel

Latch Stainless steel

Tube Stainless steel

## EXTRACTOR TUBE ACSI (FLAT, ROUND)

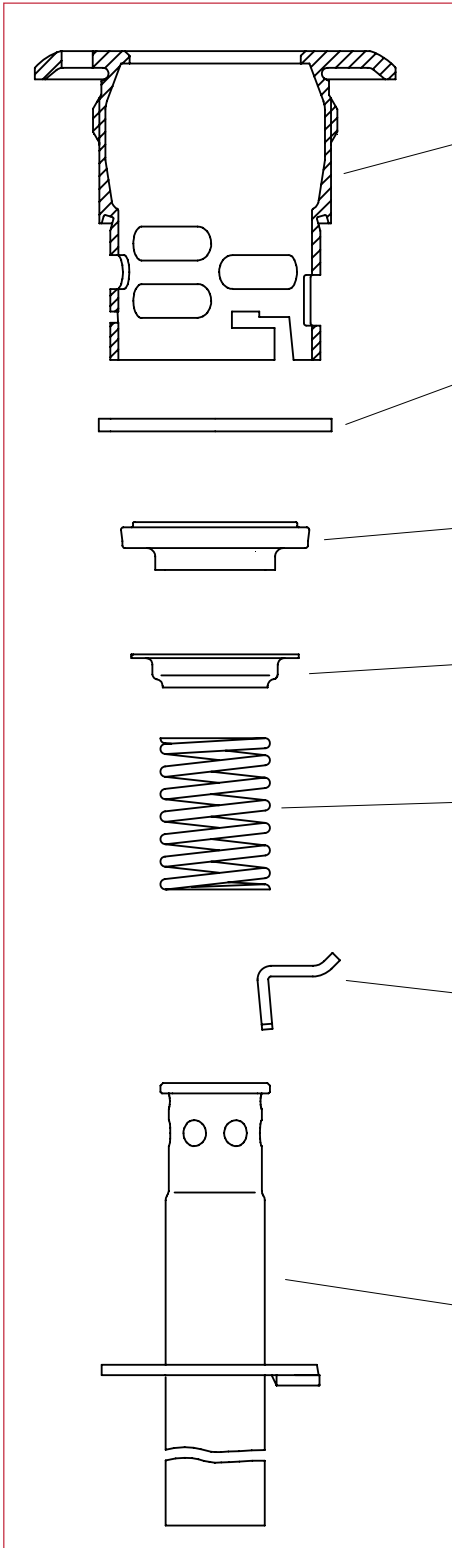

Body Stainless steel

Sealing ring Rubber

Main seal Rubber

Main seal plate stainless steel

Spring Stainless steel

Latch Stainless steel

Tube Stainless steel

# EXTRACTOR TUBE GRSI



DISPENSE SYSTEMS

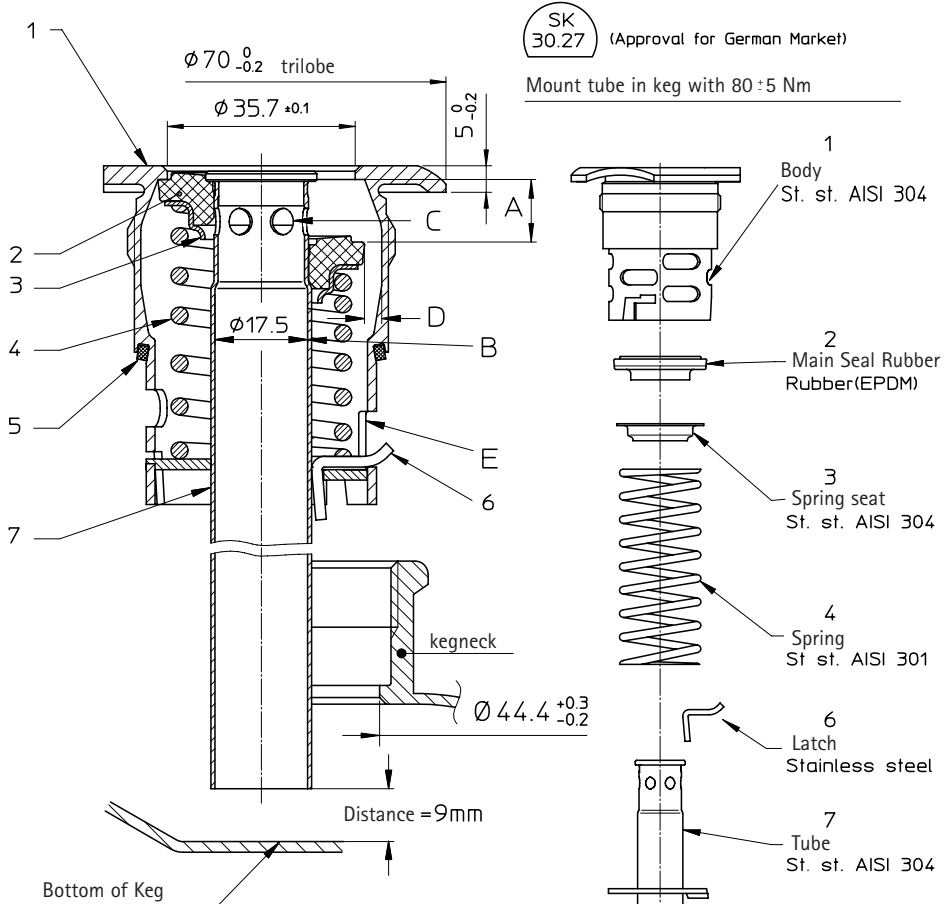

SK 30.27 (Approval for German Market)

Mount tube in keg with 80±5 Nm

I	Stroke Main Seal Part2 - Part1	A	12mm
II	Passage through Innertube Part7 Ø17.5	B	240mm <sup>2</sup>
	6 Holes in Part7	C	121mm <sup>2</sup>
III	Passage through Outertube Part1-Part2	D	467mm <sup>2</sup>
	Passages in Part 1	E	1164mm <sup>2</sup>
IV	Temperature Resistance	Shorttime 135°C	

			DATE	NAME	TITLE			
			DRAWN	2002/10/08	1126	Technical datasheet Extractor Tube GRSI		
			APPR.					
			NORM	2005/05/31	00:00:00			
			PROD. DEV.	NL				
			<b>DSI</b>		PROJ. METHOD	FORMAT	DRAWING NUMBER	SHEET
						A4	D184676	1
			REPL.	01126	REPL. BY		1 SHTS	
Δ	ALTERATIONS	DATE	NAME	ORIGIN				

# EXTRACTOR TUBE ACSI



DISPENSE  
SYSTEMS

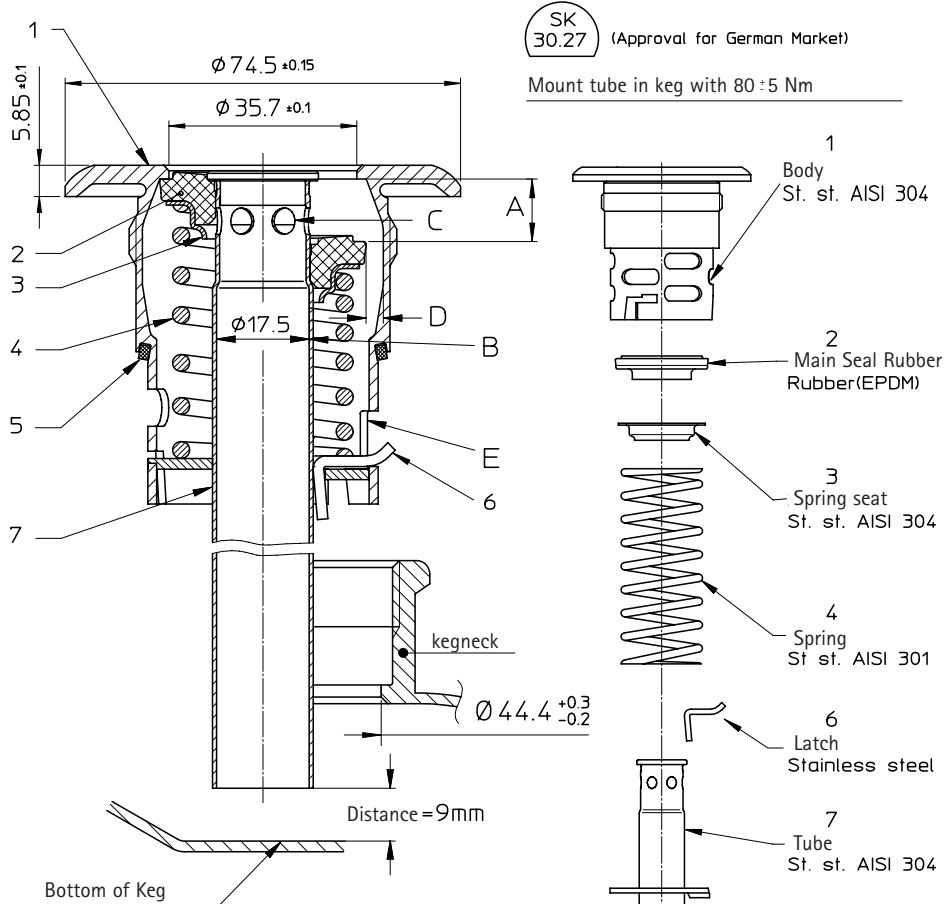

I	Stroke Main Seal Part2 - Part1	A	9-12mm
II	Passage through Innertube Part7 $\phi 17.5$	B	240mm <sup>2</sup>
	6 Holes in Part7	C	121mm <sup>2</sup>
III	Passage through Outertube Part1-Part2	D	467mm <sup>2</sup>
	Passages in Part 1	E	1164mm <sup>2</sup>
IV	Temperature Resistance	Shorttime 135°C	

		DATE	NAME	TITLE			
	DRAWN	2002/10/31	17-31A1	Technical datasheet Extractor Tube ACSI			
	APPR.						
	NORM	2005/05/31	00:0000				
	PROD. DEV.		NL				
				PROJ. METHOD	FORMAT	DRAWING NUMBER	SHEET
					A4	D184706	1
ALTERATIONS				REPL.	D111	REPL. BY	1 SHTS

## 7. Dimensions

ET-GR, GRS, GRSI



ET AC, ACS, ACSI



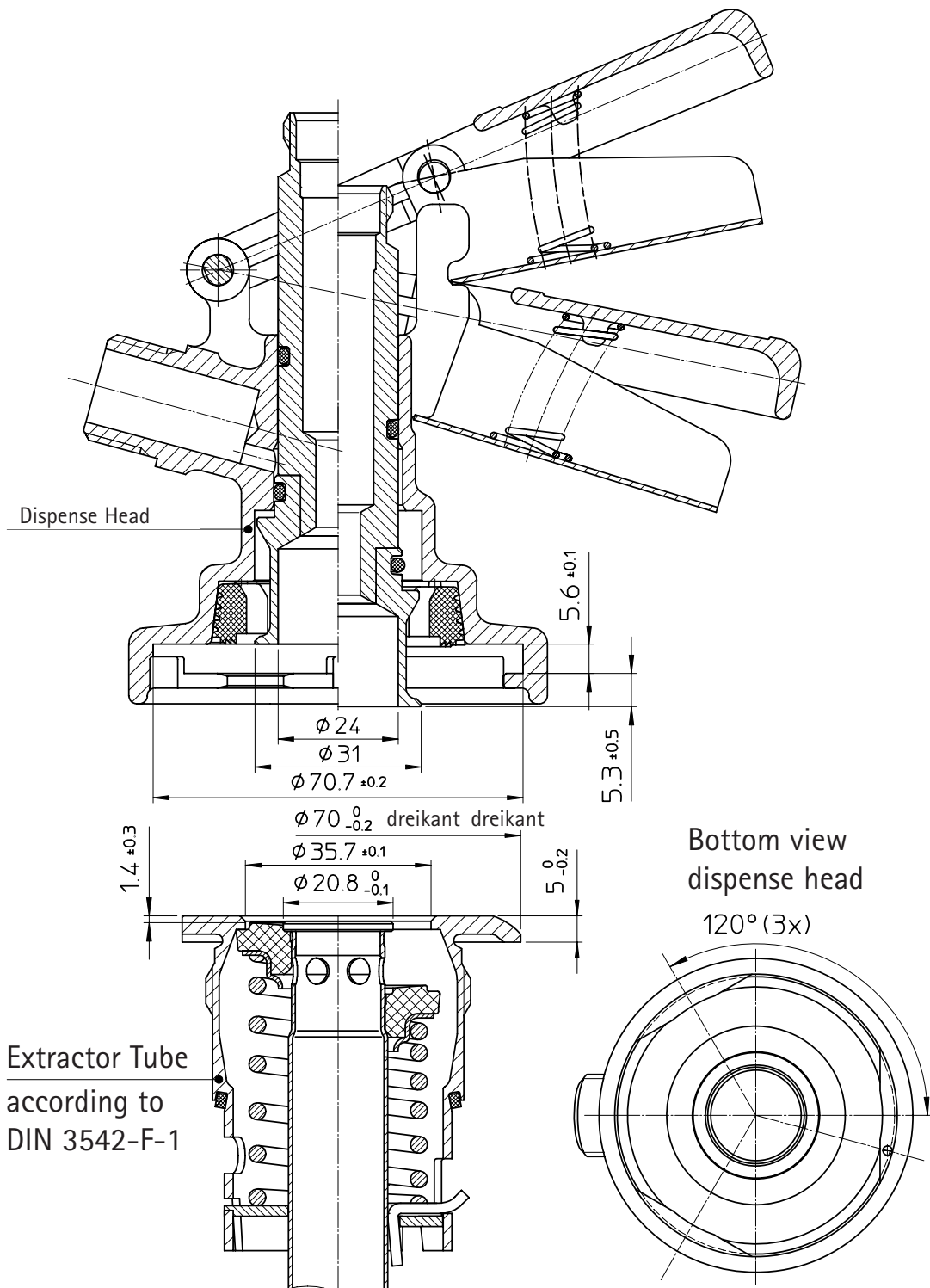

# FLAT TYPE CONNECTION SYSTEM AC

