



DISPENSE
SYSTEMS
INTERNATIONAL

MOUNTING - DISMOUNTING

ASSEMBLING - DISASSEMBLING
INSTRUCTION

for

DSI Extractor Tube

ET-WD

ET-WB



INSTRUCTION

Quality Management:

Michael Brüseke: (0049) (0)2385-772-512
e-mail: brueseke@dsi-group.net

Yilmaz Kodas: (0049) (0)2385-772-452
e-mail: kodas@dsi-group.net

Technical Department:

Christof Tuneke: (0049) (0)2385-772-430
e-mail: tuneke@dsi-group.net

Sales Department:

DSI Hamm

Sabine Groneberg: (0049) (0) 2385-772-212
e-mail: groneberg@dsi-group.net

Sandra Leszynsky: (0049) (0) 2385-772-214
e-mail: leszynsky@dsi-group.net

Renate Stosiek: (0049) (0) 2385-772-213
e-mail: stosiek@dsi-group.net

DSI GETRÄNKEARMATUREN GmbH
Gewerbepark Hamm-Rhynern
Oberster Kamp 20, 59069 Hamm-Rhynern, Germany
Tel: +49 (0) 23 85-77 21 00
Fax: +49 (0) 23 85-77 22 49
E-mail: info@dsi-group.net
internet: www.dispensegroup.com

DSI CZECH REPUBLIC
Závodni 50
CZ-36006 Karlovy Vary · Czech Republic
Tel: +4 20 (0) 35-3 44 90 25
Fax: +4 20 (0) 35-3 44 90 25
E-mail: dsi@volny.cz

DSI – U.K.

Unit 2
Ealand Industrial Estate
Ealand, Scunthorpe
North Lincoln Shire, DN17 4JW
United Kingdom
Tel: +44 (0) 17 24 71 23-77
Fax: +44 (0) 17 24 71 23-88
E-mail: dsiservicecenter@aol.com

Honoured partners,

You are welcome in the world of D.S.I. Dispense Systems International

More than 100 years of development and success leave behind us.

Companies as Fuge, Breitwisch, VHS or Germefa have given us a solid basis of know-how and experience on the sector of beverage technology in the past.

On this basis we have built up a new vision and have created something very Unique:

D.S.I. Unique Draught Technologies

We the D.S.I. team, resolutely focus our attention on new market orientated technologies which correspond to the requirements of our customers. We are thinking in the same way as you and especially we think in advance.

In the middle of Germany, located in Hamm/Westphalia we opened up a new chapter of our company history and set up a new manufacturing plant. This enables our 100 employees to utilise these optimal conditions for developing and manufacturing brand-new products. At the same time the certificate and review of ISO 9001 represents the principle for our high-grade quality management and obligation. Particularly one objective emphasises all our efforts.

The safety of your product with our greatest care and precision, equal whether you are filling, taping or you intend to dispense without problems. We aim to offer you 100% quality from production up to consumption.

We see ourselves as your partner in the field of beverage industries and offer you a constructive dialogue about solutions to the necessary tasks we are faced with every day. For this D.S.I. takes the responsibility with its well-known name. We are prepared to be challenged by you.

Please do it.

With kind regards



J. Stein
-General Manager-

MOUNTING - DISMOUNTING
ASSEMBLING - DISASSEMBLING
INSTRUCTION
TECHNICAL INFORMATION

ET-WD

ET-WB

ET-WD

ET-WB



Today quality and safety determine the emphasis of all our activities. Security of your employees and colleagues plays an essential role in the daily application with our equipment as well as the easiest handling in installation and dismantling of our systems.

Specialised sealing systems made of high-grade materials are in daily utilisation with all our types of extractor tubes. Due to continuous improvement of our technology we are able to equip nearly all systems with a five year's guarantee.

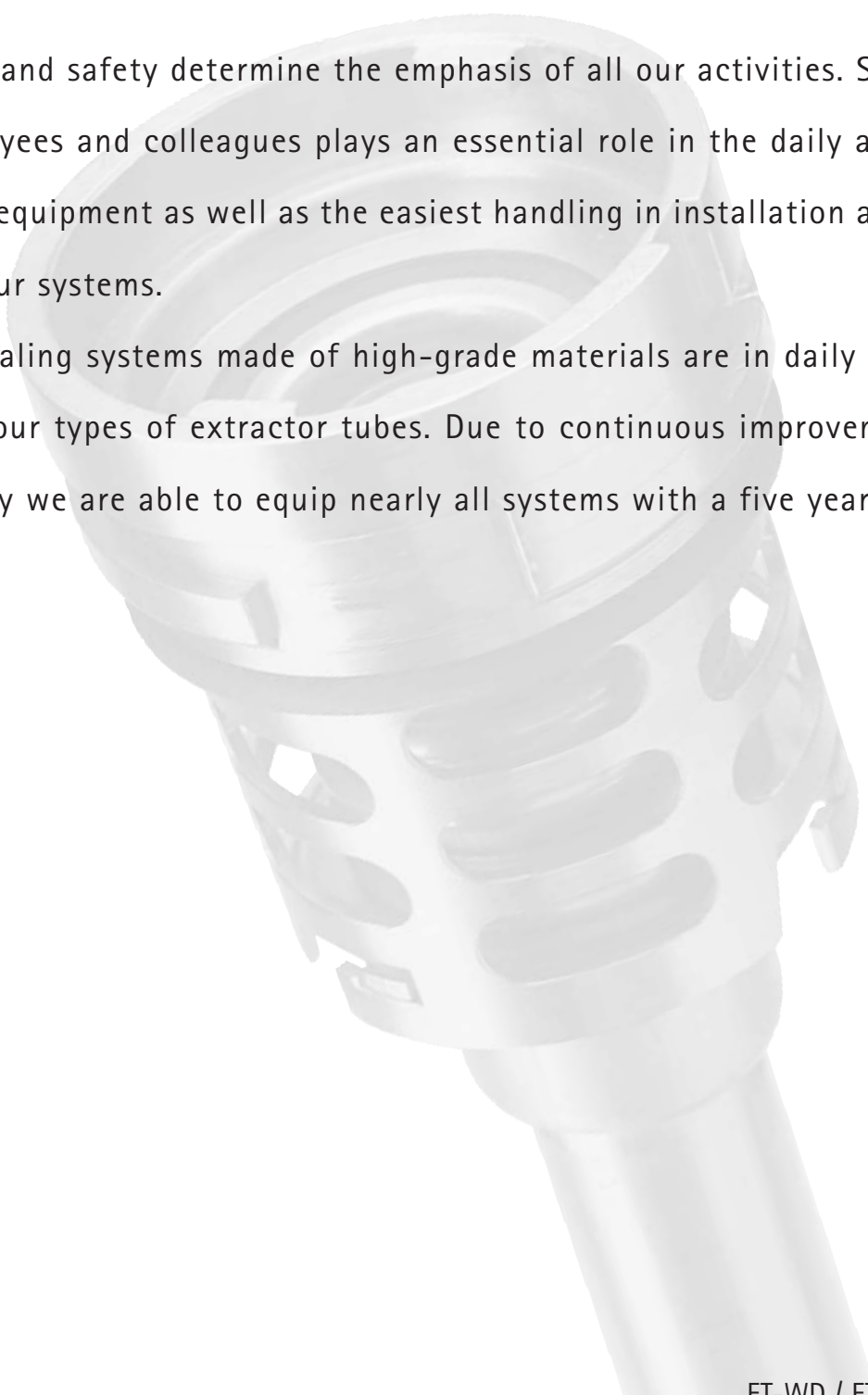

1. Mounting instruction
2. Dismounting instruction
3. Disassembling intruction
4. Assembling instruction
5. Listing of required tools
6. Technical information
7. Dimensions

1. Mounting instruction

ET-WD



ET-WB



FITTING INSTRUCTION

EXTRACTOR TUBE **WD**



1. Moisten the extractor tube in water.

2. Check if the keg neck is clean.

3. Insert the Extractor Tube straight.
Align the two outside lugs of the
extractor body with the two gaps in
the top of the keg neck.

4. Turn the extractor tube clockwise
until it is locked in the keg neck.

EXTRACTOR TUBE **WD**

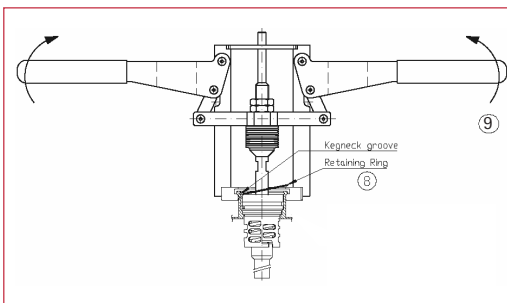
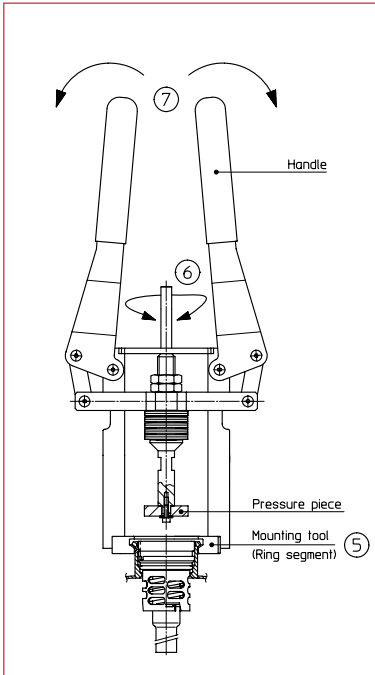

- Put the ring segment of the DSI mounting tool 027349.3 around the keg neck.

Put the retaining ring on the pressure piece of the mounting tool as illustrated:

- Align the slots in the pressure piece of the mounting tool with the lugs on the extractor tube body, e.g. by rotating the complete tool.
- Press the extractor tube into the keg neck by rotating the handles of the mounting tool to horizontal position.
- Feed the retaining ring gradually into the groove of the keg neck. Make sure that the ring has totally sprung back fully into the groove.
- Rotate the handles of the mounting tool to vertical position and take the tool off.

EXTRACTOR TUBE **WB**

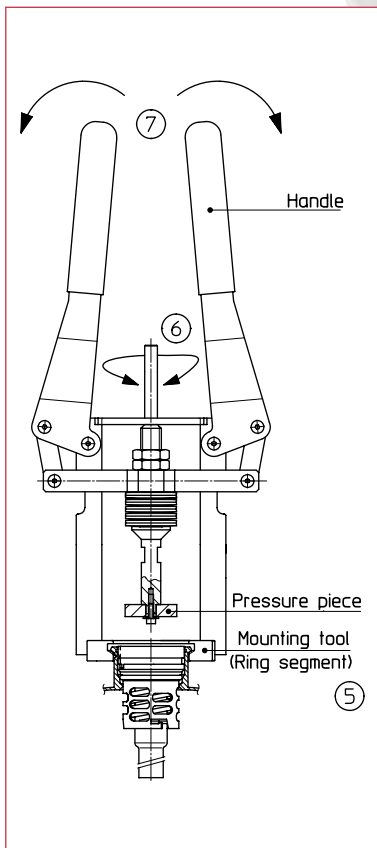
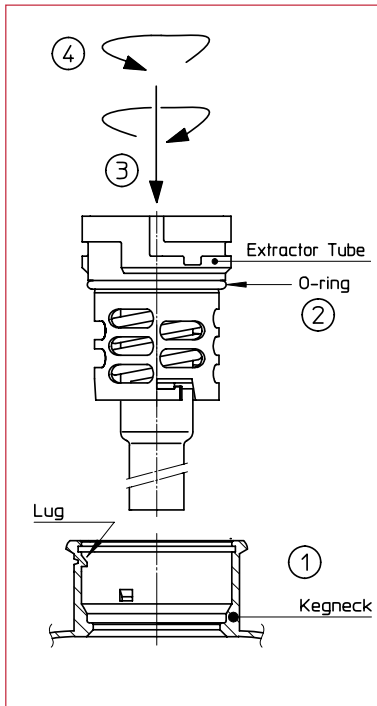

1. Check if the kegneck is clean
2. Moisten the O-ring with some water
3. Put the extractor tube in the keg and rotate the extractor tube clockwise until it is locked (the upper lug of the kegneck is aligned with the big slot in the extractor tube Body)
4. Rotate the extractor tube anti-clockwise until it is locked in the kegneck
5. Put the ring segment of the DSI mounting tool 027349.3 around the keg neck.
6. Align the slots in the pressure piece of the mounting tool with the lugs on the extractor tube body, e.g. by rotating the complete tool.
7. Press the extractor tube into the keg neck by rotating the handles of the mounting tool to horizontal position.

EXTRACTOR TUBE **WB**

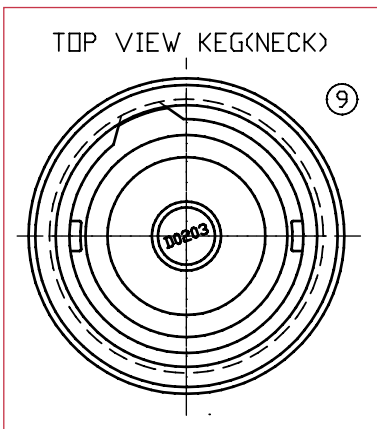
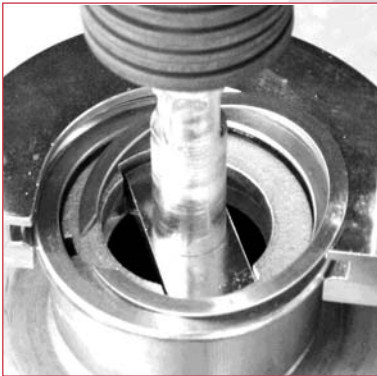
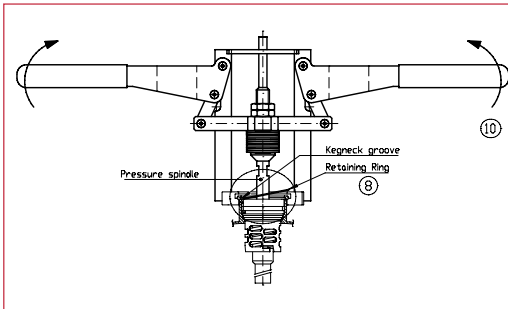

8. Put the retaining ring (026993.1) around the pressure spindle of the mounting tool by bending the ring just a little bit (see photo).
9. Feed the retaining ring gradually into the groove of the keg neck. Make sure that the ring has totally sprung back fully into the groove.
10. Rotate the handles of the mounting tool to vertical position and take the tool off.

2. Dismounting instruction

ET-WD



ET-WB



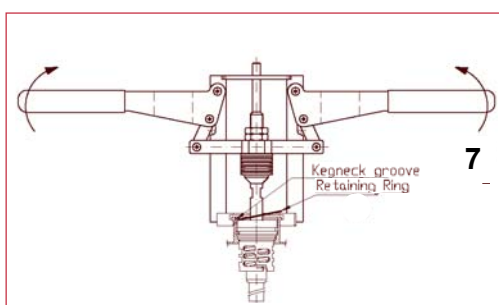
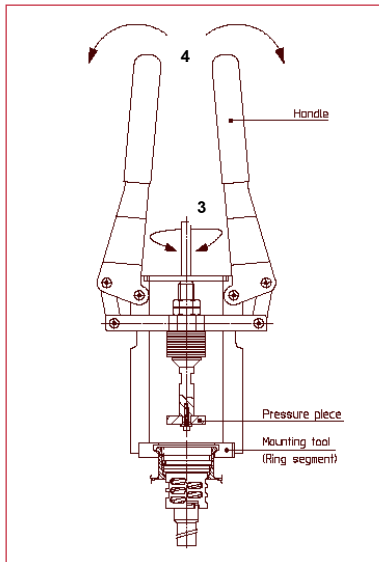

1. Decompress the keg, e.g. by means of the DSI decompression tool 026826.8.
2. Put the ring segment of the DSI mounting tool 027349.3 around the keg neck.
3. Align the slots in the pressure piece of the mounting tool with the lugs on the extractor tube body, e.g. by rotating the complete tool.
4. Press the extractor tube into the keg neck by rotating the handles of the mounting tool to horizontal position.
5. Use the DSI retaining ring remover 027468.1 to get the ring out of the keg neck groove.
6. First take out the last winding and then remove the retaining ring gradually out of the groove.
7. Rotate the handles of the mounting tool to vertical position and take the tool off. Remove the extractor tube from the keg by lifting it and rotating it anti-clockwise.

Do not re-use the retaining ring!

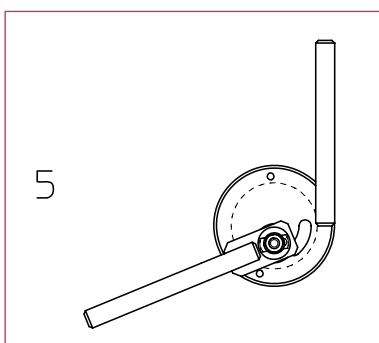
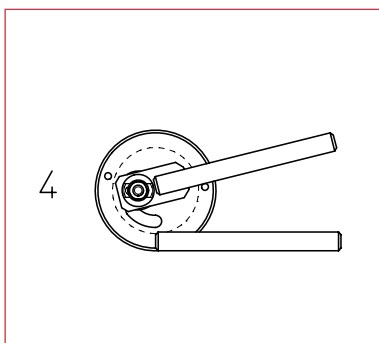
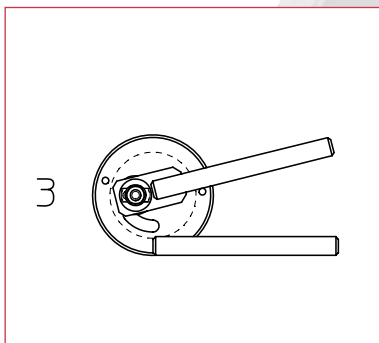
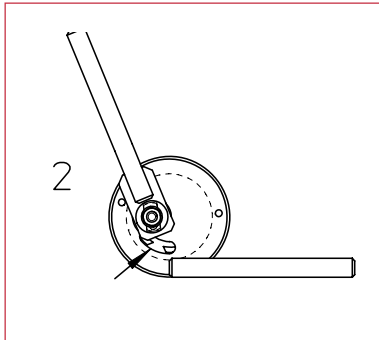

1. Decompress the keg, e.g. by means of the DSI decompression tool 026826.8.
2. Place the circlip removal tool (DSI Art. Nr. 027369.1 flat and with open handles (against detention pin) on the kegneck.
Rotate the tool until the opening of the circlip is visible through the curved slot.
3. Close the handles until detention pin. The right side of the circlip will rise.
4. Rotate the complete tool with closed handles about 270° in clockwise direction until the circlip is released from the kegneck.
5. Open the handles (until detention pin)
6. Remove the tool from the kegneck. Remove the extractor tube from the keg by lifting it and rotating it clockwise until the extractor tube can be taken out.

Do not re-use the circlip!

3. Disassembling instruction

ET-WD



ET-WB



DISASSEMBLING DSI EXTRACTOR TUBE WB / WD

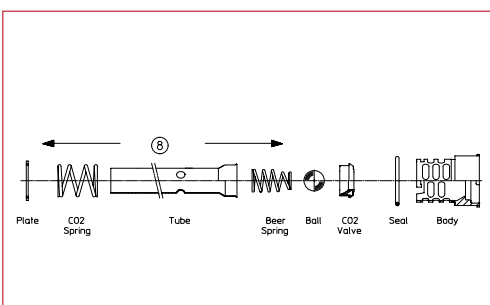
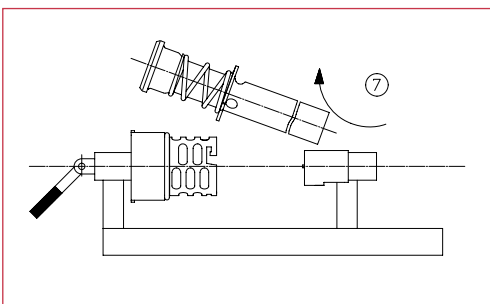
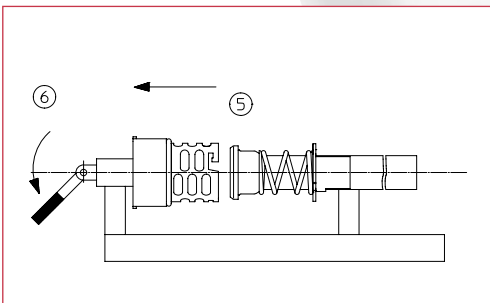
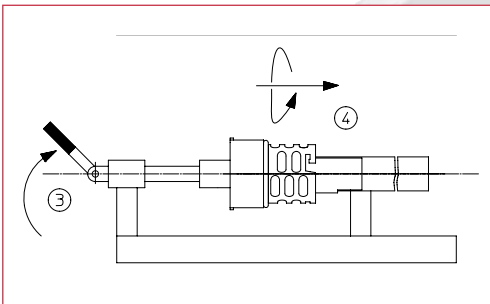
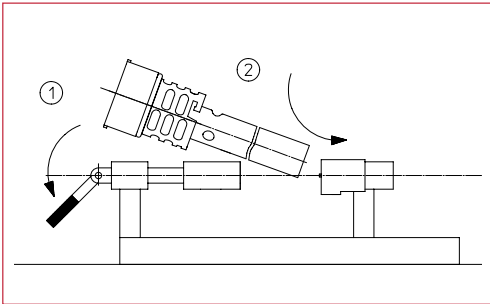

1. Push the handle of the DSI disassembling tool backward.
2. Put the extractor tube in the tool. Make sure that the pin of the tool fits into the hole in the bottom of the extractor tube plate.
3. Pull the handle forward.
4. Pull the body downwards and turn it anticlockwise until it is unlocked.
5. Move the body upwards and connect it to the tool by turning the body 90°.
6. Push the handle backward.
7. Take the subassembly out. Take the body off.
8. Disassemble all parts.

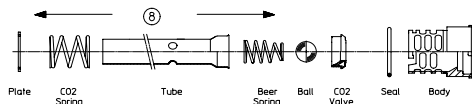

4. Assembling instruction

ET-WD



ET-WB



ASSEMBLING INSTRUCTIONS EXTRACTOR TUBE WB / WD

Do all the actions of the disassembling instruction in the opposite order:

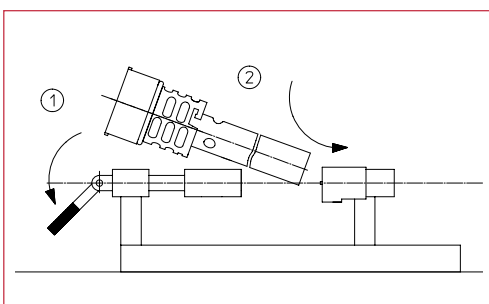
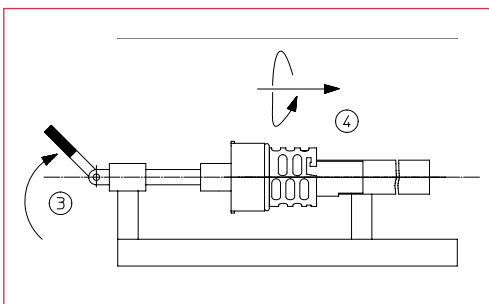
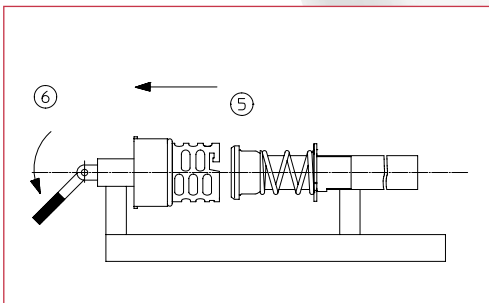
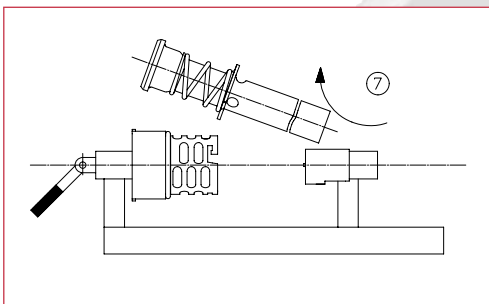
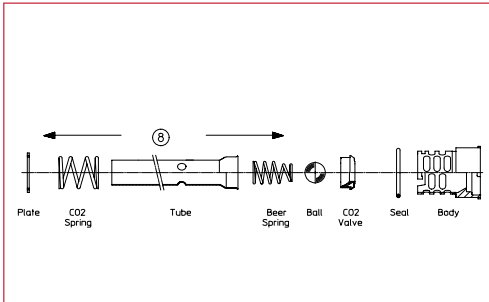

(8) Put the beer spring, ball and CO2 valve in the tube, and push the parts together. Assemble the rest of the parts

(7) Connect the body to the DSI assembling tool. Put the subassembly in the tool. Make sure that the pin of the tool fits into the hole in the bottom of the extractor tube plate.

(6) Pull the handle forward.

(5) Move the body downwards.

(4) Pull the body downwards and turn it clockwise until it is locked to the extractor tube plate.

(3) Push the handle backward.

(2) Take the extractor tube out of the assembling tool.

5. Listing of required tools

ET-WD



ET-WB



TOOLS, WELL TYPE EXTRACTOR TUBES,
THREADLESS



Decompression tool

article-no.: 026826.8

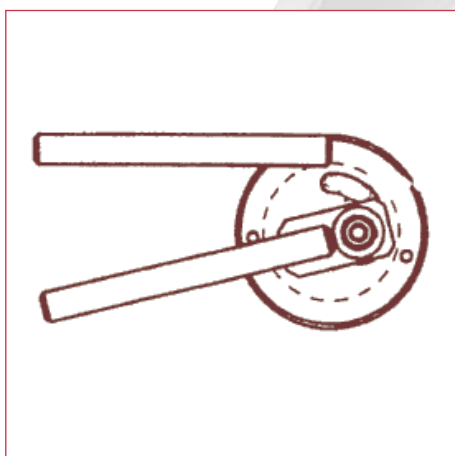

Spring remove tool WB

article-no.: 027369.1

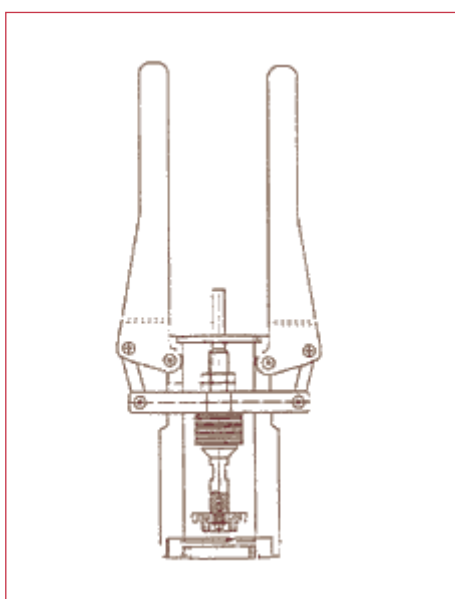

Extractor tube mounting tool WB/WD

article-no.: 027349.3

TOOLS, WELL TYPE EXTRACTOR TUBES,
THREADLESS

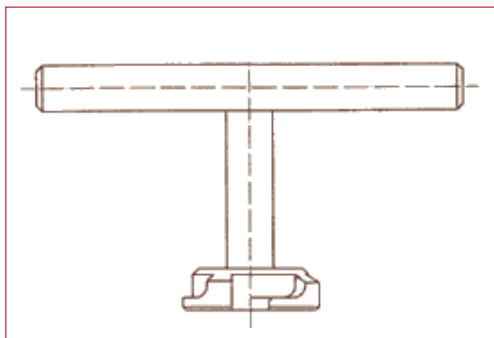

Demounting tool

article-no.: 027389.1

WB

article-no.: 027386.7

WD



Assembling and disassembling tool

article-no.: 027410.9

WB

article-no.: 027466.1

WD

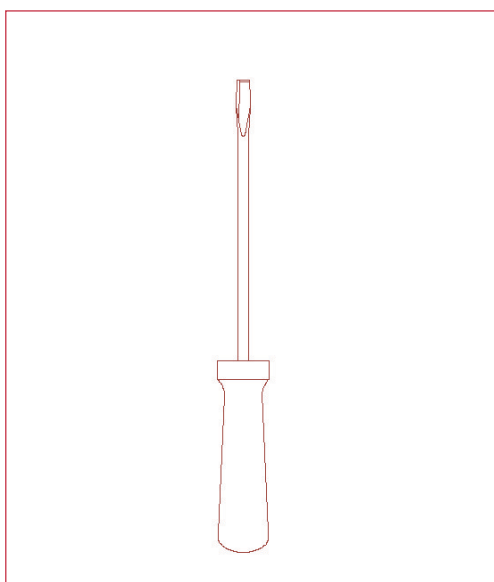

Retaining ring removal tool WD

article-no.: 027468.1

6. Technical information

ET-WD



ET-WB



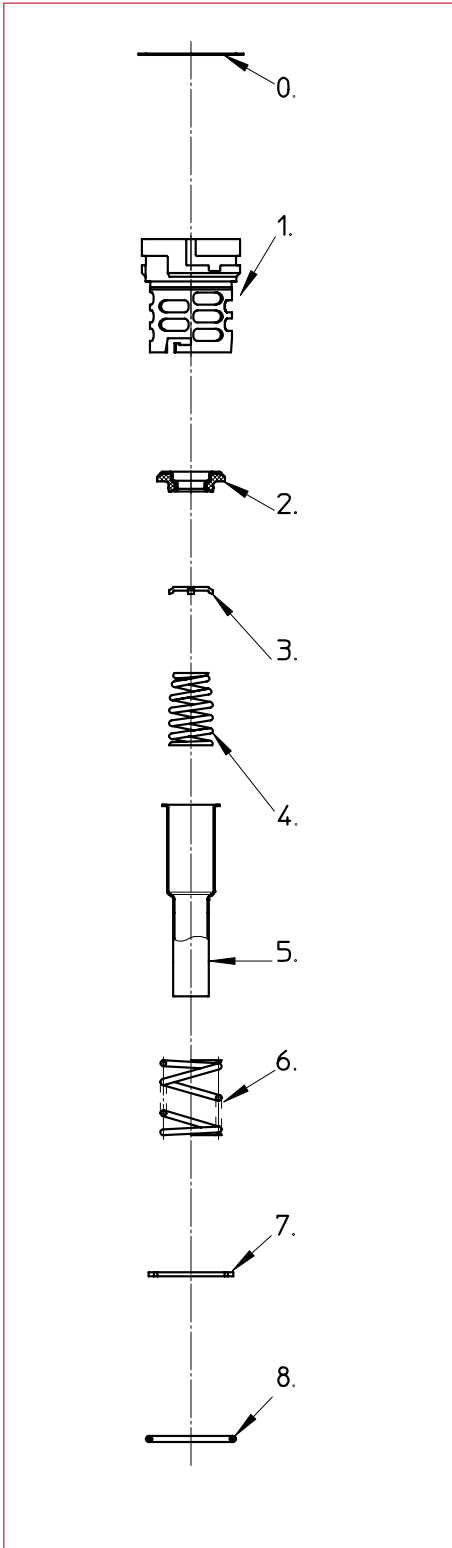

- 0. 026993.1
Retaining ring-St/St 302
- 1. 026842.2
Extractor body St/St 304 threadless
- 2. 026692.6
CO2 Valve-St/St 316 rubber BGA XXI Cat. 1
- 3. 026237.2
Beervalue-St/St 304
- 4. 026238.3
Spring-St/St 301
- 5. Tube-St/St 304
- 6. 025367.1
Spring-St/St 301
- 7. 554352.7
Locking plate-St/St 304
- 8. 026419.8
O-ring - rubber BGA XXI Kat. 1

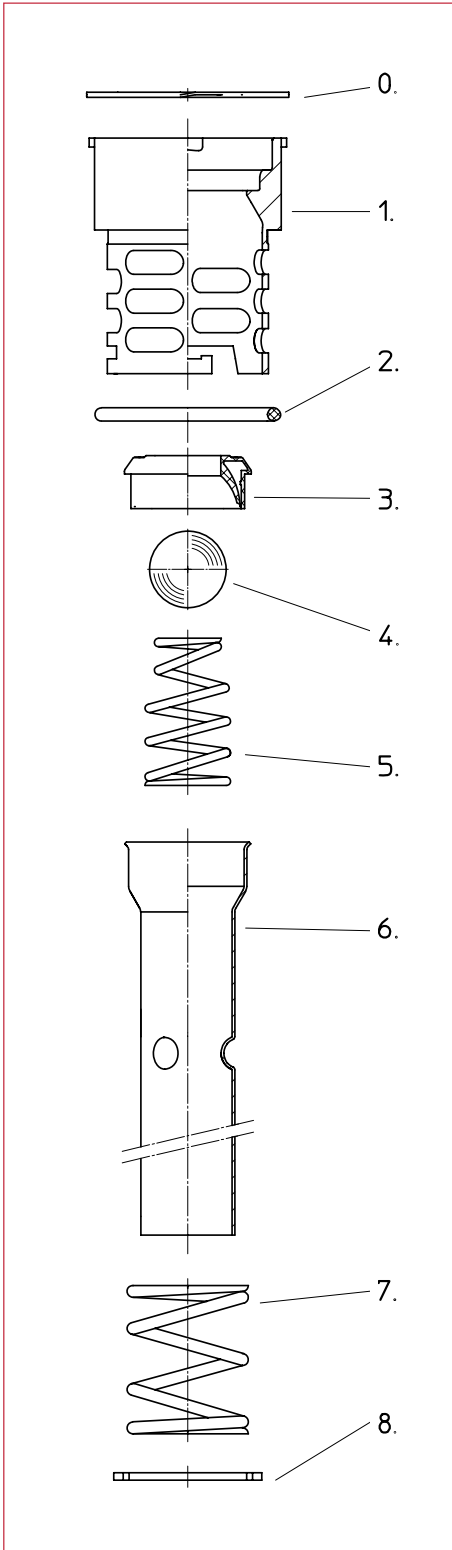

- 0. 026709.1
Retaining ring Stainless steel
- 1. 026702.5
Body Stainless steel
- 2. 026419.8
O-ring Rubber
- 3. 026704.7
Valve, CO2 Rubber
- 4. 026703.6
Ball Stainless steel
- 5. 026706.9
Spring, beer Stainless steel
- 6. Down tube
Stainless steel
- 7. 026705.8
Spring, CO2 Stainless steel
- 8. 554352.7
Locking plate Stainless steel

EXTRACTOR TUBE WB



DISPENSE SYSTEMS

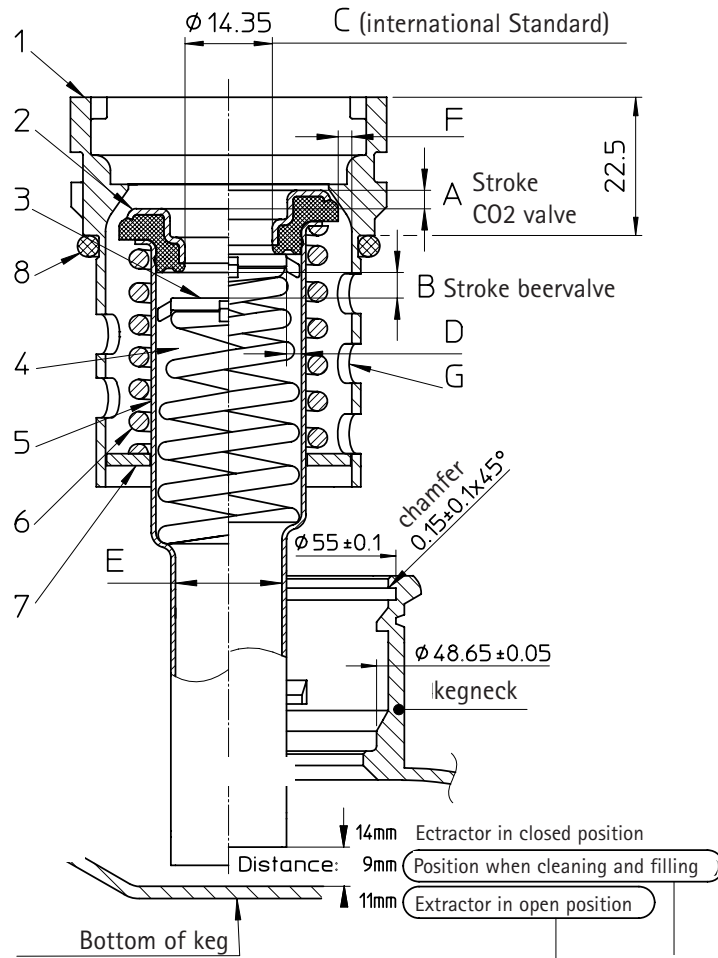

I	Stroke	CO2 Valve and Tube	Parts 2+5 - Part 1	A	3mm	max. 4mm-6mm
		Beervalue	Part 3 - Part 2	B	4mm	6.5mm-8mm
II	Passages through Innertube		In Part 2 $\varnothing 14.35$	C		161mm ²
			Part 3 - Part 5	D		125mm ²
			In Part 5 $\varnothing 17.5$	E		240mm ²
III	Passages through Outertube		Part 1 - Part 2	F		238mm ²
			Part 1	G		1660mm ²
IV	Temperature Resistance			Shorttime	135°C	

EXTRACTOR TUBE WD



DISPENSE SYSTEMS

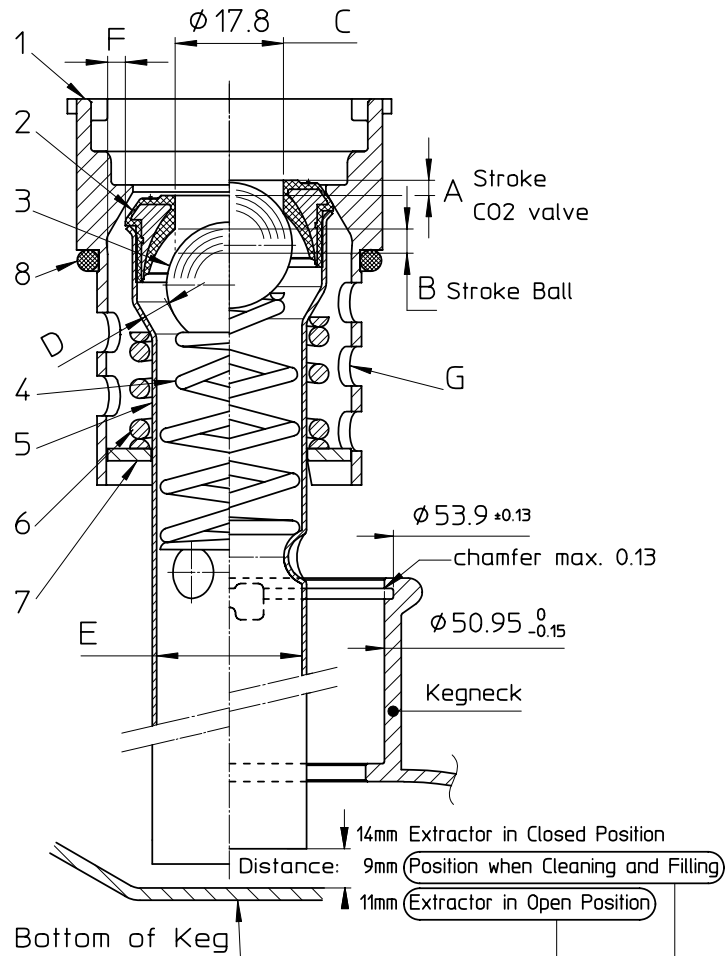

I	Stroke	C02 Valve and Tube	Parts 2+5 - Part 1	A	3mm	max. 4mm-6mm
		Ball	Part 3 - Part 2	B	4mm	6.5mm-8mm
II	Passages through Innertube		In Part 2 $\varnothing 17.8$	C		250mm ²
			Part 3 - Part 5	D		260mm ²
			In Part 5 $\varnothing 23.9$	E		450mm ²
III	Passages through Outertube		Part 1 - Part 2	F		330mm ²
			Part 1	G		1660mm ²
IV	Temperature Resistance	Shorttime 140°C				

7. Dimensions

ET-WD



ET-WB



